



**AMETEK**

**LAMB ELECTRIC**

**Product Bulletin**

**Advantek II - Plus**

**Model: 122111-00**

**SPECIAL FEATURES**

- Suitable for 120 volt AC operation, 60 Hz
- UL recognized, category PRGY2 (E47185)
- Provision for grounding
- Skeleton-frame construction
- **Patented Advantek II diffusion**
- **Tapered high efficiency fan system**
- **Self Hold (7AM) thermal device**
- The Lamb vacuum motor line offers a wide range of performance levels to meet design needs

**DESCRIPTION**

- One stage
- 120 volts
- 5.7"145 mm diameter
- Ball/ Ball bearings
- Single speed
- Thru-flow discharge
- Thermoset fan end bracket
- Steel End-bracket

**DESIGN APPLICATION**

- Equipment operating in environments not requiring separation of working air from motor ventilating air
- Designed to handle clean, dry, filtered air only

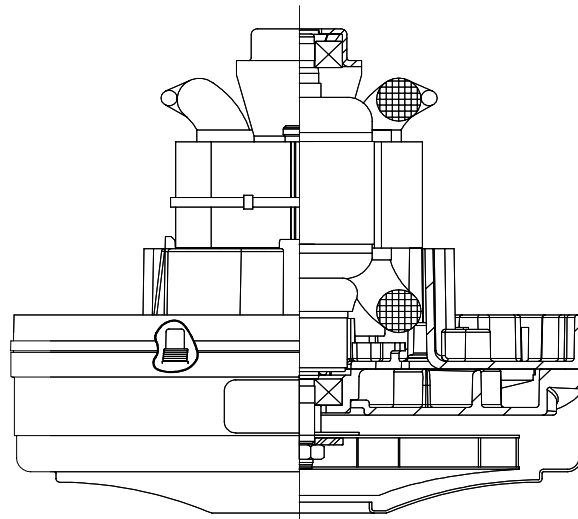

**TYPICAL MOTOR PERFORMANCE.\***

(At 120 volts, 60Hz, test data is corrected to standard conditions of 29.92 Hg, 68° F.)

**A  
S  
T  
M  
  
D  
A  
T  
A**

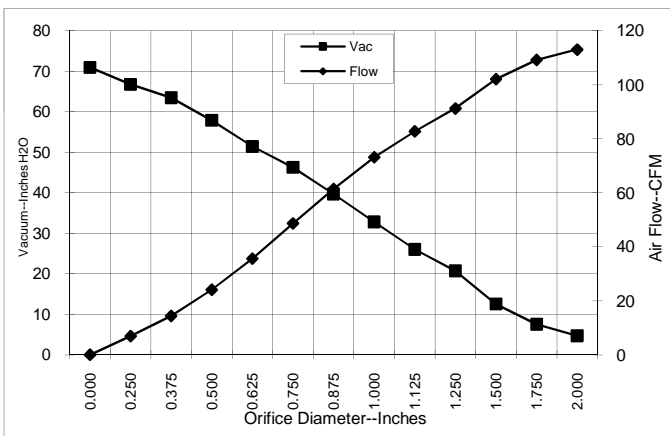

Orifice (Inches)	Amps	Watts (In)	RPM	Vac (In.H <sub>2</sub> O)	Flow (CFM)	Air Watts
2.000	6.6	756	21815	4.7	113.1	63
1.750	6.6	759	21755	7.6	109.3	97
1.500	6.7	783	22050	12.6	102.1	151
1.250	6.7	775	22325	20.7	91.3	223
1.125	6.6	765	22555	26.0	82.8	254
1.000	6.4	745	22900	32.8	73.2	283
0.875	6.2	719	23615	39.7	61.5	287
0.750	5.8	684	24430	46.3	48.7	265
0.625	5.4	637	25600	51.5	35.6	215
0.500	5.0	585	26975	57.9	24.1	164
0.375	4.6	545	28210	63.5	14.4	107
0.250	4.3	504	29495	66.8	6.9	54
0.000	4.1	483	30930	71.0	0.0	0

**M  
E  
T  
R  
I  
C  
  
D  
A  
T  
A**

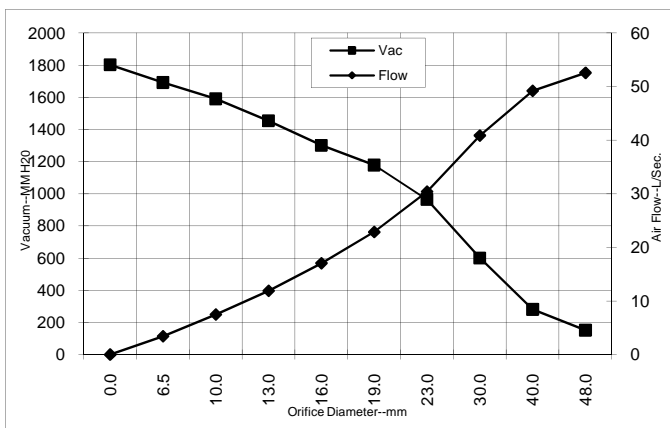

Orifice (mm)	Amps	Watts (In)	RPM	Vac (mm H <sub>2</sub> O)	Flow (L/Sec)	Air Watts
48.0	6.6	757	21789	151	52.6	78
40.0	6.7	776	21962	281	49.2	135
30.0	6.6	769	22452	601	40.9	240
23.0	6.2	726	23436	965	30.4	286
19.0	5.8	683	24453	1178	22.9	264
16.0	5.4	639	25553	1302	17.1	217
13.0	5.0	590	26838	1454	11.9	169
10.0	4.7	551	28025	1591	7.5	116
6.5	4.3	506	29431	1692	3.4	57
0.0	4.1	483	30930	1802	0.0	0

Note: Metric performance data is calculated from the ASTM data above.

\* Data represents performance of a typical motor sampled from a large production quantity. Individual motor data may vary due to normal manufacturing variations.

<b>Test Specs:</b> 120 volts	<b>Minimum Sealed Vacuum:</b> 66.0	<b>ORIFICE:</b> 7/8"	<b>Minimum Vacuum:</b> 36.0	<b>Maximum Watts:</b> 769
------------------------------	------------------------------------	----------------------	-----------------------------	---------------------------

