



**DESCRIPTION**

- Two-Stage
- 240 volts
- 5.7"/ 145 mm diameter
- 8 mm Fan end bearing
- Double ball bearings
- Single speed
- Tangential bypass discharge
- Plastic fan end bracket
- Plastic commutator bracket

**DESIGN APPLICATION**

- Equipment operating in environments requiring separation of working air from motor ventilating air
- Designed to handle clean, dry, filtered air only

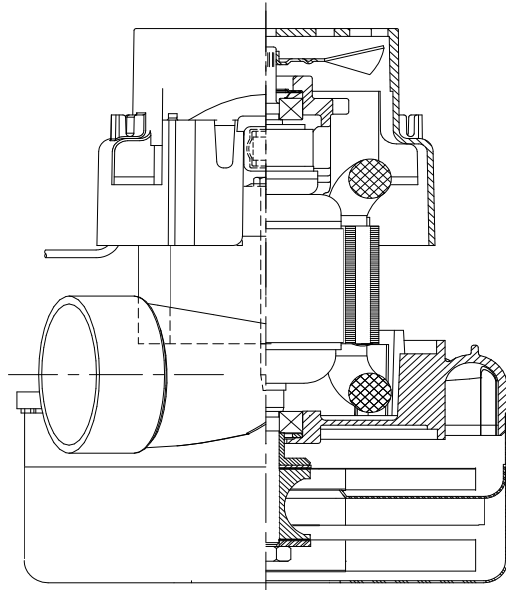

**SPECIAL FEATURES**

- Non-loading fan system
- Skeleton frame design
- Suitable for 240 volt AC operation, 50/60 Hz
- UL recognized, category PRGY2 (E47185)
- Provision for grounding
- The Lamb Electric vacuum motor line offers a wide range of performance levels to meet design needs

**TYPICAL MOTOR PERFORMANCE.\***

(At 240 volts, 60Hz, test data is corrected to standard conditions of 29.92 Hg, 68°F.)

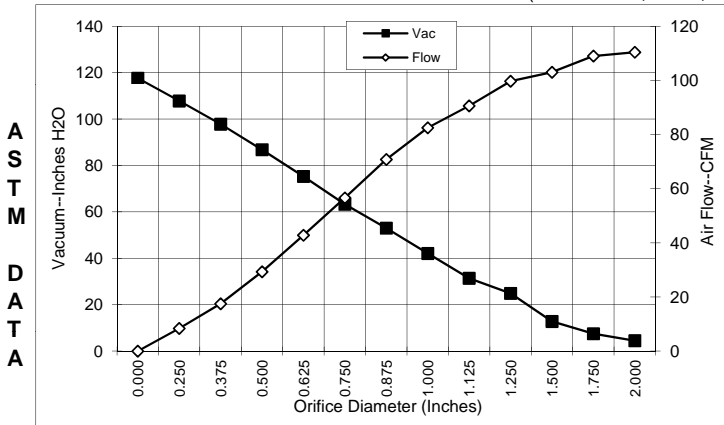

Orifice (Inches)	Amps	Watts (In)	RPM	Vac (In.H <sub>2</sub> O)	Flow (CFM)	Air Watts
2.000	6.8	1565	21763	4.5	110.4	58
1.750	6.8	1565	21760	7.5	109.0	96
1.500	6.9	1565	21700	12.8	103.0	155
1.250	6.8	1561	21700	24.9	99.7	292
1.125	6.7	1551	21830	31.4	90.6	335
1.000	6.7	1527	21963	42.1	82.5	409
0.875	6.5	1482	22300	53.0	70.8	441
0.750	6.1	1405	22928	63.3	56.6	422
0.625	5.7	1310	23813	75.3	42.8	379
0.500	5.2	1195	25066	86.8	29.3	299
0.375	4.6	1073	26440	97.8	17.5	201
0.250	4.2	972	27946	107.8	8.4	107
0.000	3.8	896	29523	117.6	0.0	0

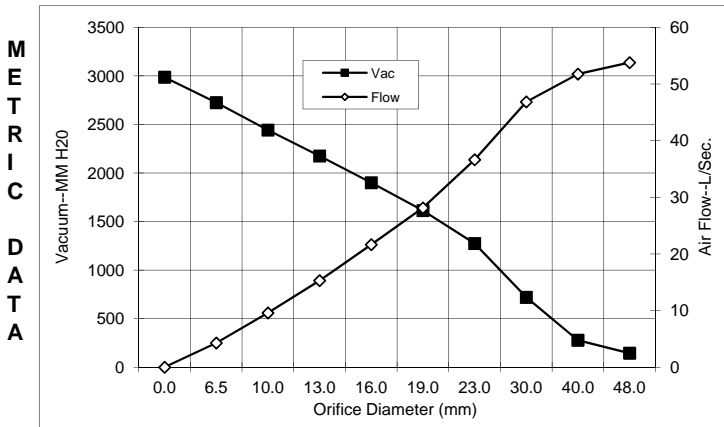

Orifice (mm)	Amps	Watts (In)	RPM	Vac (mm H <sub>2</sub> O)	Flow (L/Sec)	Air Watts
48.0	6.8	1565	21762	145	53.8	76
40.0	6.9	1565	21718	278	51.8	141
30.0	6.7	1556	21772	720	46.8	331
23.0	6.6	1493	22216	1274	36.6	458
19.0	6.1	1403	22946	1614	28.1	446
16.0	5.7	1314	23778	1900	21.7	404
13.0	5.3	1207	24941	2176	15.3	327
10.0	4.7	1091	26234	2442	9.6	230
6.5	4.2	977	27871	2725	4.3	115
0.0	3.8	896	29523	2987	0.0	0

Note: Metric performance data is calculated from the ASTM data above.

\* Data represents performance of a typical motor sampled from a large production quantity. Individual motor data may vary to normal manufacturing variations.

<b>Test Specs:</b>	240 volt	Minimum Sealed Vacuum: 76.1	121.0	ORIFICE: 7/8"	Minimum Vacuum: 50.0	Maximum Watts: 1765
--------------------	----------	-----------------------------	-------	---------------	----------------------	---------------------

**DIMENSIONS**

NOTES:

1. LEADS: 18GA STRANDED. LEADS CAN BE ANY COLOR EXCEPT GREEN OR GREEN WITH YELLOW STRIPE.
2. GROUND LEAD: 18GA STRANDED, GREEN OR GREEN WITH YELLOW STRIPE.
3. MOTOR IDENTIFICATION: MANUFACTURER'S NAME, MODEL NUMBER, VOLTAGE, FREQUENCY, INSPECTOR'S CODE, DATE OF MANUFACTURE, AGENCY RECOGNITION CODE, PLANT LOCATION CODE, PATENT INFORMATION, ONE OR MORE OF THE FOLLOWING PATENTS APPLY TO THIS MOTOR: 5482378; 5736805; 4669952; 4664835. AND COUNTRY OF ORIGIN.
4. ALLOW [0.0016 SQ M]/2.5 SQ IN. MIN. FOR COOLING AIR INTAKE.
5. COOLING AIR INTAKE MUST BE SEPARATED FROM COOLING AIR EXHAUST.
6. VACUUM EXHAUST MUST BE SEPARATED FROM COOLING EXHAUST.
7. MOUNTING MUST NOT RESTRICT THIS DIAMETER.

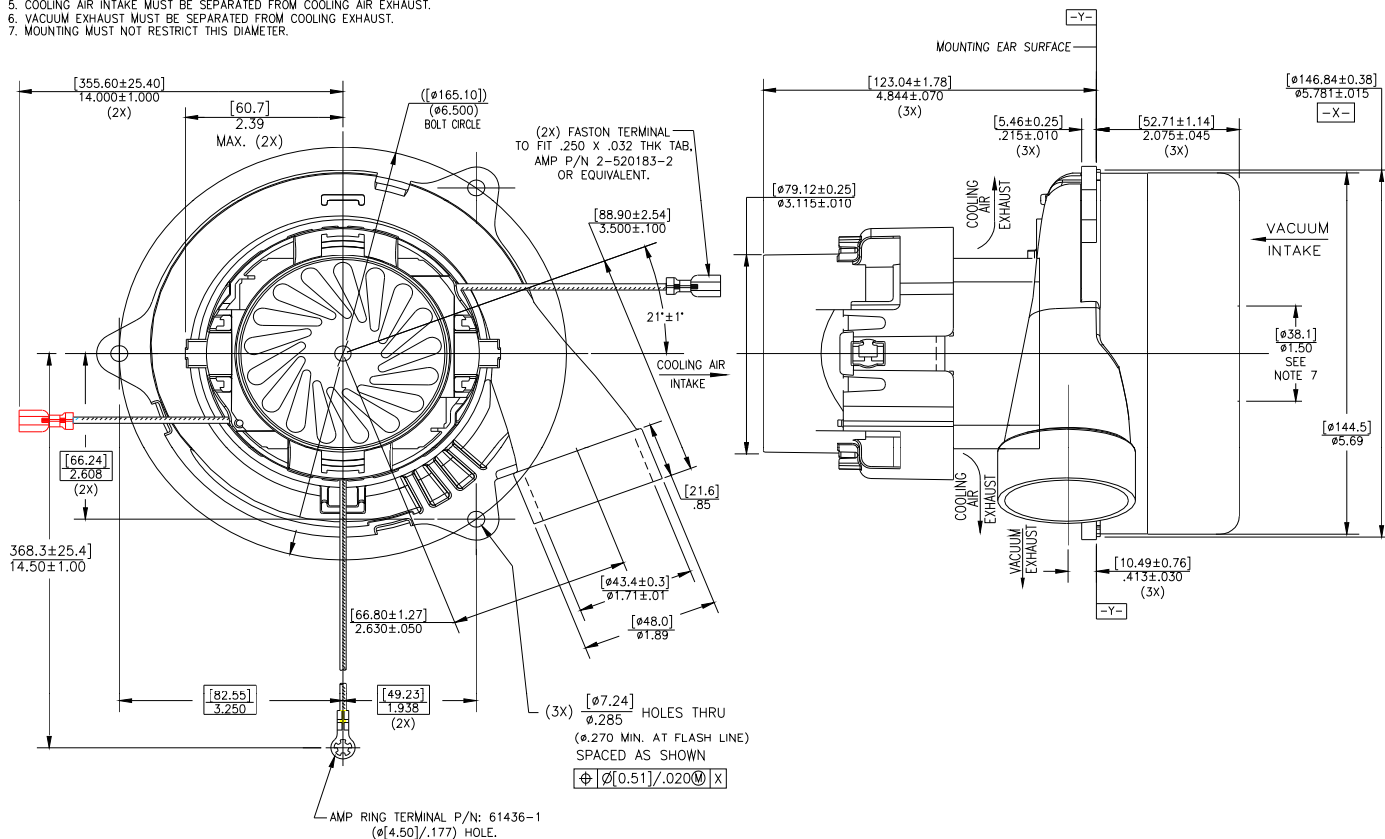

**IMPORTANT NOTE:** Pictorial and dimensional data are subject to change without notice. Contact factory for current revision levels.

**WARNING** - When using AMETEK/Lamb Electric bypass motors in machines that come in contact with foam, liquid (including water) of other foreign substances, the machine must be designed and constructed to prevent those substances from reaching the fan system, motor housing and electrical components. Lamb vacuum motors other than hazardous duty models should not be applied in machines that come in contact with dry chemicals or other volatile materials. Failure to observe these precautions could cause flashing (depending on volatility) or electrical shock which could result in property damage and severe bodily injury, including death in extreme cases. All applications incorporating Lamb motors should be submitted to appropriate organizations or agencies for testing specifically related to the safety of your equipment.

**AMETEK/Lamb Electric Division**  
**627 Lake Street**  
**Kent, Ohio 44240**  
**U.S.A.**  
**Tel: (330) 673-3786 Fax: (330) 677-3812**  
**www.lambelectric.com**